

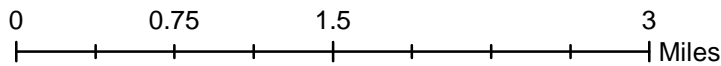

Volunteer Wildlife Monitoring Program (VWMP) Frog and Toad Survey

Route ID: 133 County: Story

Click for Google Maps to Site 1: <https://www.google.com/maps/dir/?api=1&destination=42.1773134256,-93.5408692213>

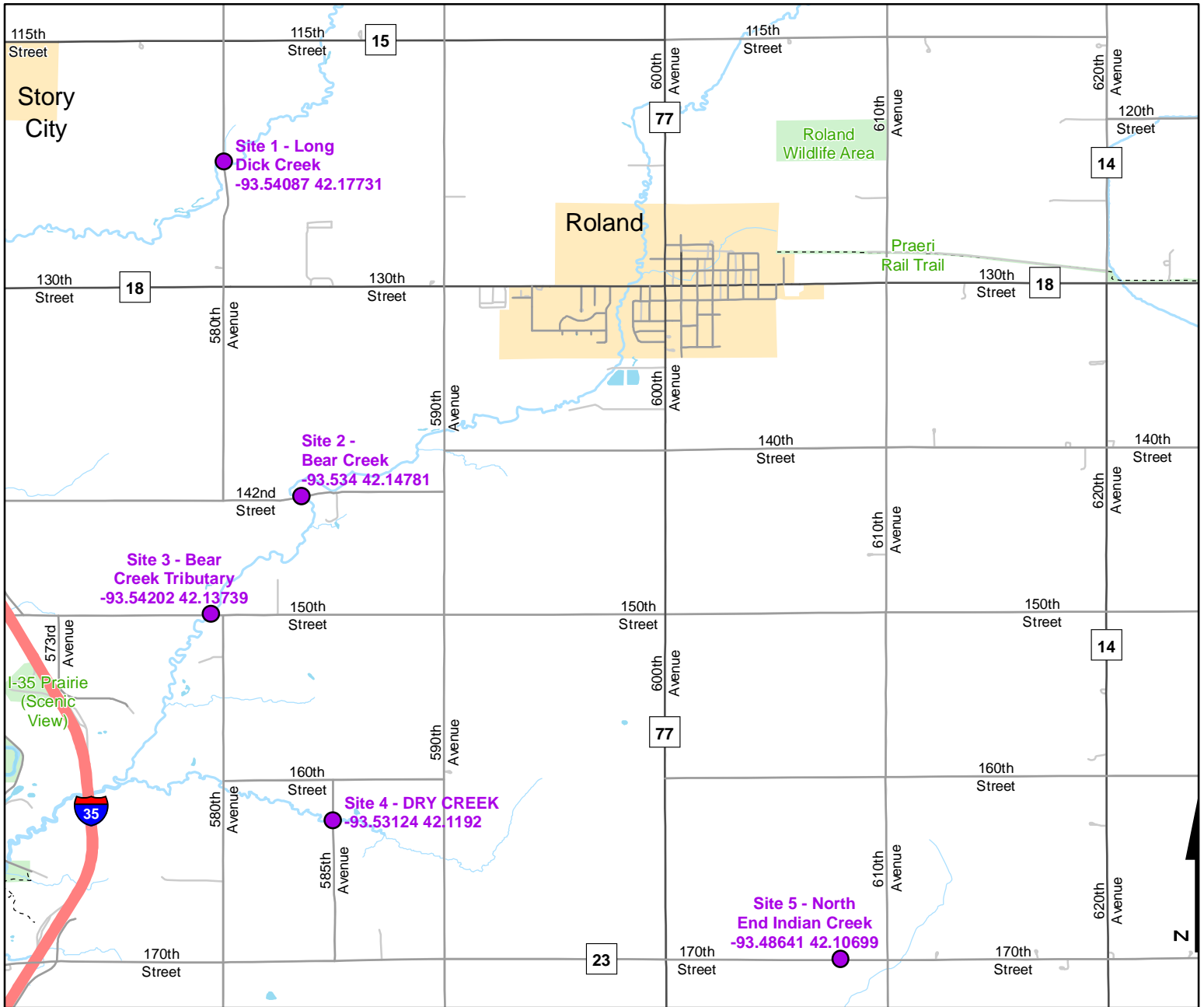

DNR
Volunteer Wildlife Monitoring Program

Legend

----- Trails

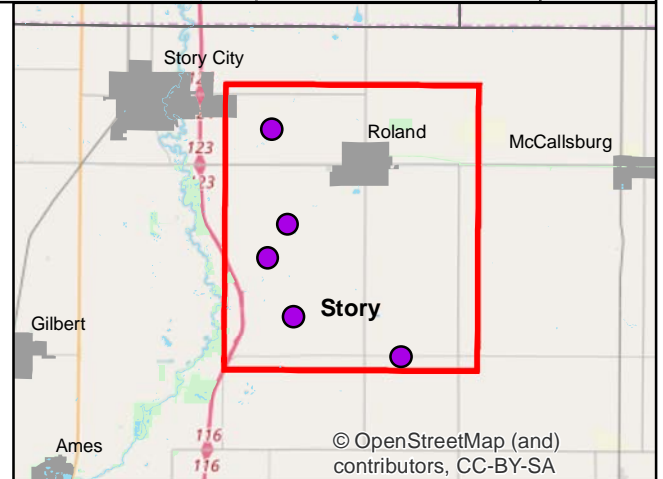

© OpenStreetMap (and) contributors, CC-BY-SA



Frog and Toad Call Survey Route Description

Route ID **133**

Established: 1994

Site Number	Name	County	Latitude	Longitude	Directions
1	Long Dick Creek	Story	42.1773134	-93.5408692	On 580th Ave, 3/4 mile north of 130th St and 580th Ave intersection on bridge over Long Dick Creek
2	Bear Creek	Story	42.1478137	-93.5339978	On 142nd Ave bridge over Bear Creek, 0.35 miles east from 580th Ave and 142nd St intersection
3	Bear Creek Tributary	Story	42.1373917	-93.5420178	On 150th St on bridge over Bear Creek, just west of 150th St and 580th Ave.
4	DRY CREEK	Story	42.1192041	-93.5312413	1/4 mile south of 160th St and 585 Ave intersection, on 585th Ave on bridge over Dry Creek
5	North End Indian Creek	Story	42.106992	-93.4864122	1/4 mile west of E. Matthews St and 610th Ave intersection